

Product Code:.....

UDI-DI Number:.....

User Name: .....

*The product code and UDI-DI number  
are located on the label.*

THIS USER GUIDE IS APPLICABLE FOR THE FOLLOWING  
**BURNETT REMOULD VACUUM-  
MOULD PRODUCTS ONLY:**

BATHING FAMILY

- BS1103 Bathing Back & Side Support
- BS1109 Bath Seat with full body support (Adult)
- BS1110 Bath Seat with full body support (Junior)
- BS1111 Seahorse Shower Seat with back & side support

CHAIR FAMILY

- BS1100 Full Chair Support (Adult)
- BS1101 Full Body Insert (Junior)
- BS1102 Full Body Insert (Infant)
- BS1104 Back, Head & Side Chair Support (Adult)
- BS1108 Back, Head & Side Chair Support (Junior)
- BS1105 Bucket Seat Pushchair Support (Infant)
- BS1106 Bucket Seat Pushchair Support (Junior)
- BS2000 Trekinetic Wheelchair Support

CAR FAMILY

- BS1115 Full Body Car Seat (Adult)
- BS1116 Back, Head & Side Car Seat Support (Adult)
- BS1117 Back, Head & Side Car Seat Support (Junior)

LUMBAR FAMILY

- BS1150 Lumbar Support
- BS1151 Back/Seat Support
- BS1152 Back Support Extended Length (Standard)
- BS1153 Back Support Extended Length (Large)

HEAD FAMILY

- BS1155 Butterfly Head Support
- BS1157 Head & Neck Support (Adult)
- BS1156 Head & Neck Support (Child)

SLEEP FAMILY

- BS1120 Sleep System Wedge Style

THERAPY FAMILY

- BS1140 Wedge Prone Support (Small)
- BS1141 Wedge Prone Support (Large)
- BS1142 Wedge Prone Support (Extra Large)
- BS1162 Therapy Mattress/Theatre Support (Full Length)
- BS1163 Therapy Mattress/Theatre Support (Half Length)

ISSUE DATE: 12/07/24  
VERSION: UG/BRM-VAC-EN04  
STATUS: APPROVED  
AUTHORISED BY: Technical Director

  
.....  
J. ASH

## 1. GENERAL



### WARRANTY:

The BURNETT REMOULD® products covered in this User Guide have been awarded a ONE YEAR WARRANTY. Any manufacturing defect will be rectified free of charge. Product damage through wear and tear, neglect or accidental damage is not covered by the warranty.

## 2. PRODUCT SAFETY



### 2.1 GENERAL:

- 2.1.1. All competent persons should ever use these devices.
- 2.1.2 A competent person should assess the use of the product prior to use.
- 2.1.3 It is essential that the equipment is fit for purpose; the correct size and type of product for an individual is essential to ensure the safety and comfort of the user.
- 2.1.4 Product care and inspection instructions should be followed at all times.
- 2.1.5. We advise that vulnerable users are not left unattended when using this equipment.
- 2.1.7 **If there is any doubt about equipment safety, remove the equipment from use until checked and authorised for use by a competent person.**

### 2.2 EQUIPMENT INSPECTION:

- 2.2.1 Care & Independence recommend pre-use equipment checks by a competent person to ensure the equipment is free from defects.
- 2.2.1 Regularly:
  - i. Wash as per instructions. This will ensure the product is kept fresh and hygienic.
  - ii. Check suction cups for wear and tear. Contact Care & Independence for replacement suction cups if required.
- 2.2.3 Quarterly: Check any valves for wear around seal plunger. Contact Care & Independence should a replacement valve be necessary.
- 2.2.4 Every 6 months: Check pump.
  - i. Ensure tube is not split.
  - ii. Hook and nozzle are still integral and operational.
  - iii. Air evacuates correctly.



- 2.2.5 Bi-Annually: Check seams for wear and tear. Contact Care & Independence in the event of any deterioration.

## 3. DAMAGED OR FAULTY PRODUCT



Care & Independence have a strict *Returns & Repair Procedure* to ensure the safety of all involved.

Please **do not** send products back without completing the Return/Repair form.

## 4. PRODUCT CARE



### 4.1 GENERAL CARE:

- 4.1.1 Discolouration to some materials or fading labels may occur as a result of use over time.

NOTE: It is a recommended that the product label remain legible throughout the product's working lifetime but is not currently a statutory requirement.

- 4.1.2 To avoid piercing the appliance, do not use around sharp objects.

### 4.2 ADDITIONAL PRODUCT CARE FOR BATHING ENVIRONMENT

- 4.2.1 Ensure surfaces are free of all deposits of oils, soaps and any powders left by cream mousses or cleaners.
- 4.2.2 Ensure bath surface is free from any limescale deposits. Clean the surface if feeling dull or rough to touch.
- 4.2.3 Bath water should be a mix of hot and cold. **Do not fill with hot water only** as this will distort the casing and suction cups.



### 4.3 CLEANING THE PRODUCT:

- 4.3.1 After use, the product should be cleaned with particular attention being paid to any crevices plus seams and suction cups to remove any deposits.
- 4.3.2 It is recommended to use clean warm water with diluted detergent. Diluted disinfectants may also be used for hygiene.

#### 4.3.3 Do not use bleach or agents containing bleach.

#### 4.3.4 Towel dry after use.

#### 4.3.5 Keep product and bath surface free from limescale, soap, hairs and fibres.

#### 4.3.6 Hard water areas; we advise removing suction cups from the press studs and soaking in a diluted de-scaling solution to remove any deposits. We recommend this is conducted with a monthly frequency.



#### 4.4 DECONTAMINATION:

To avoid cross-contamination in an institutional setting, a three-tiered cleaning approach is recommended: warm, non-abrasive cleaner and anti-bacterial solution.

Please be aware of any infection control policies that may in force locally or appropriate to multi-user scenarios.

#### 4.5 CLEANING THE COVERS:

Refer to to individual washing machine instructions for best results.

NOTE: Repeated washing may lead to sling deterioration. Care & Independence strongly recommend replacing the cover at the first signs of wear or damage, as opposed to after a specified time frame.

**A copy of these instructions should be provided to the person(s) laundering the cover.**

##### 4.5.1 Quilted Cotton:



- Machine wash gently at 40°C to avoid shrinkage.
- Use a mild soap solution or a non-biological detergent without bleaching additives.
- Do not add bleach or stain removers.
- Natural or tumble dry on a cotton setting.
- Do not place on hot pipes or heaters. Keep away from flames.
- Do not iron.

##### 4.5.2 3D-Spacer Covers:



- Machine wash gently at 40°C to avoid shrinkage.

NOTE: May be washed at 90°C to aid infection control but monitor for shrinkage.

- Use a mild soap solution or a non-biological detergent without bleaching additives.
- Do not add bleach or stain removers.
- Natural or tumble dry on a cotton setting.
- Do not place on hot pipes or heaters. Keep away from flames.
- Do not iron.

## 5. GETTING TO KNOW YOUR PRODUCT

### 5.1 PRODUCT LABELS EXPLAINED

There is one label associated with each BURNETT REMOULD® product. The UDI-DI number is a unique identification number for the product line - it is not be confused with an individual serial number. BURNETT REMOULD® products are not issued with serial numbers.

*Example label:*

LOGO	MANUFACTURER INFO		
FIRE SAFETY INFO			
PRODUCT INFO: SKU, UDI-DI NO, DATE OF MANUFACTURE		QR CODE	CERTIFICATION MARKS
CERTIFICATION MARKS			

## 6. OPERATIONAL INSTRUCTIONS

Before using, check that the equipment is in safe and clean condition and is the appropriate size and model for the person to be serviced. There are a variety of ways to use and adjust this equipment, so please read carefully.

**NOTE:** Before starting the moulding process, we recommend ensuring beads are appropriately distributed inside the product casing:

- The more beads in a given area, the more support is achieved. *E.g. If a user leans to the left, distribute more beads to the left section.*
- For products with apertures *e.g. commode style*, it is important to have more beads pooled further away from the aperture as this enables the forming of a more supportive wedge shape during the following re-mould processes.

### PART 1. Preparing product for Moulding

6.1 After locating the valve on the product, attach the pump (applies to both foot and hand pump).

- With the hooked clip part opened [Fig. 1], push the white nozzle of the pump adaptor over the bottom of the black valve base until it is fully secured [Fig. 2].
- Clip the hooked part of adaptor over the top of the valve (red button part) to secure the adaptor in place [Fig. 3].

**NOTE:** The hook clip can only be connected to the front of the valve due to placement of the two side pieces.

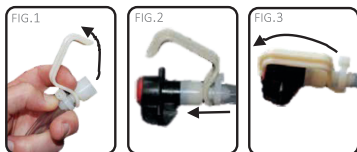

6.2. Pumping instructions to extract air. Select either A or B as appropriate.

(A) Hand pump instructions:

Holding the hand pump in your dominate hand, repeatedly squeeze pump to extract the air from the pouch [Fig.4]. Continue until product pouch has reached a semi-hardened yet malleable consistency akin to putty.



OR

(B) Foot pump instructions:

Place the foot pump on a flat preferably floored surface, and begin to work the pump by placing foot on top of pump and repeatedly compressing the foot pump enabling air to be extracted from the pouch [Fig.5]. Continue until product pouch has reached a semi-hardened yet malleable consistency akin to putty.



6.3 Remove the pump adaptor and manipulate the now semi-compressed beads by pushing, massaging or kneading until the desired supportive shape is achieved [Fig. 6].

**NOTE:** To achieve the perfect moulding shape required, it is recommended to have the user present during this stage if possible.

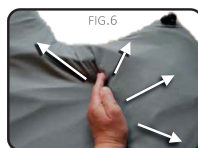



6.4 Once required shape is achieved, reinsert the pump and reactivate the appropriate pumping method until the product casing has been transformed into a firm form that can no longer be manipulated (the surface of the product casing should resemble the texture of orange peel. [Fig.7]).

NOTE: Once firmed, the product will maintain the moulded shape for up to approximately three weeks. However to maintain the optimal moulded shape for an individual user need over time, we recommend re-applying the pump regularly.



6.5 Remove the pump adaptor from product.

- Undo the hooked clip from the valve by gently pulling the hooked part clear [Fig.8].
- Remove the pump nozzle from the valve by gently pulling away [Fig.9].

NOTE: Do NOT push the red button whilst removing the clip as this will reintroduce air into the pouch and compromise the mould.

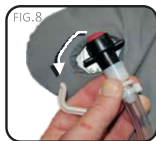

6.6 Transfer the the moulded product into the in-situ environment, e.g. Bath or shower chair, ensuring the valve is at the top and positioned away from user's body [Fig.10].



6.7 Where appropriate, attach the suction cups to the environment surface.

NOTE: Ensure all suction cups are stuck to the surface before introducing any water.

- *To attach suction cups:* position product where required and press firmly down to secure each cup to surface [Fig.11].
- *To remove suction cups:* break the seal at point of contact by gently lifting one edge [Fig.12]. This will release the pressure and allow the cup to unstick from the surface. Repeat for additional suction cups until the entire product has become free.

NOTE: Do NOT rip suction cups away from surface as this will cause stress to the casing at point of suction cup attachment and may result in a weakened join over time.

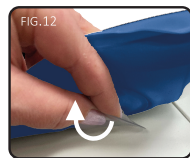
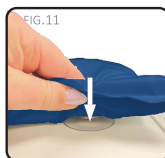

6.8 Transfer user into in-situ position as normal.

CAUTION: Once the product is submerged in water, DO NOT PRESS THE RED BUTTON on the valve, otherwise water will be sucked into the product rendering it unusable.



## PART 2. Preparing product for Re-Moulding

In the event that the product requires re-moulding *e.g. change in user posture or user growth*, follow these instructions to reintroduce air back into the product casing to revert the support back into a malleable state.

6.9 Using your digit finger and thumb, depress the top of the valve (red button) for 3-5 seconds. This will reintroduce air to the casing returning it to a fully malleable state.

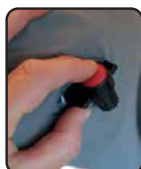

6.10 To re-mould the support, repeat instructions in Part 1 of this guide.

## 7. INSTRUCTIONS FOR AIRCRAFT USE

If using a vacuumed BURNETT REMOULD® product onboard an aircraft, it is important to be aware of the following:

- 1) At flight altitude (usually 30,000 feet), the cabin pressurises. The effect to the BURNETT REMOULD® product is that air will rapidly be introduced back into the product casing, causing the support to lose its vacuumed moulded structure. Thus the pump will need to be reattached to re-extract the air to return the support to a firm moulded support.
- 2) Upon descent from altitude, the opposite effect occurs and the product support will become more firm. It may therefore be required to depress the red valve button to reintroduce a small amount of air to the casing for user comfort without losing the moulded shape entirely.

## 8. ADDITIONAL SUPPORT



SCAN QR CODE FOR;

- Product information
- Videos
- User Guide



Free product training is also offered. Please contact us for further information.



- Expert advice
- Full support

# BURNETT ReMould® USER GUIDE



Younique Healthcare Limited  
275 Halesowen Road, Old Hill, Halesowen, West Midlands, B64 6NP  
Email: [sales@yuniquehealthcare.co.uk](mailto:sales@yuniquehealthcare.co.uk) | Web: [www.yuniquehealthcare.co.uk](http://www.yuniquehealthcare.co.uk) |  
WhatsApp: 07508 281556

*If a third party supplier has provided the BURNETT  
REMOULD® product, you may like to write their  
contact details here:*

CERTIFIED  
ISO 9001



Citation ISO Certification  
ISO  
45001:2018

